

 INSTALLATION GUIDE

**OBEX**  **CORTEX<sup>4FR</sup>**

0560FR

# Self Adhesive Interface Sealing Membrane

Class B

Version 01.01.01

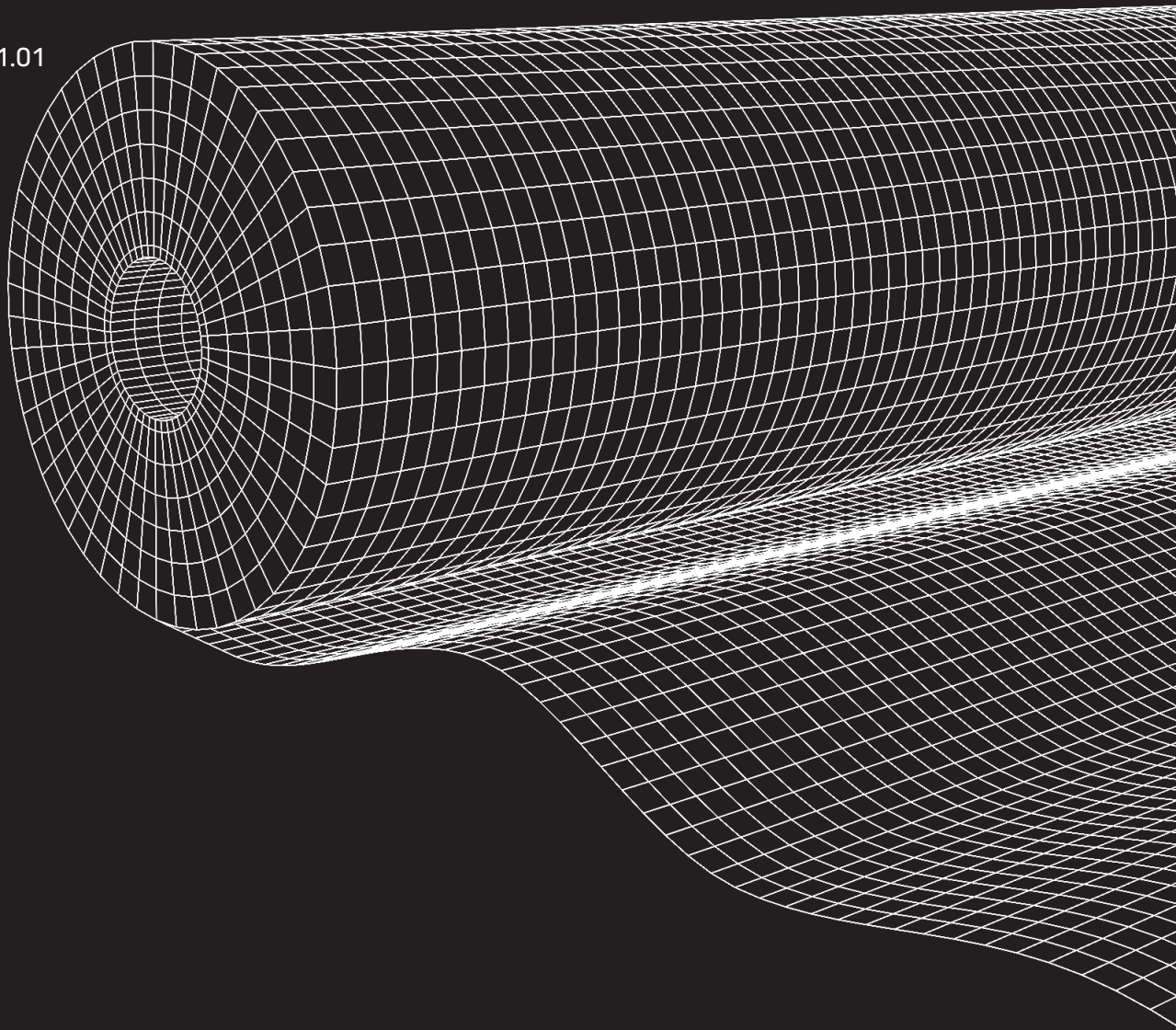

 **OBEX**<sup>®</sup>

# Contents

<b>Standard Window Installation</b> .....	<b>03</b>
---	-----------

## Important Notes

- » Porous substrates may require priming using OBEX CORTEX 0785 Primer or OBEX CORTEX 0786 Spray Primer. Bond testing must be carried out to ascertain whether priming is required. In cases of doubt the Certificate holder's advice should be sought.
- » The required overlap between members and porous materials (concrete, brick) is 100mm.
- » For non-porous materials, we recommend a minimum of 20mm-30mm.
- » Make sure to adequately cap off all edges of the membrane with paste, leaving no exposed edges.
- » The rolls may invariably contain joins. These should be overlapped and bonded by a minimum of 50mm.
- » This membrane has a fibrous construction.

0560FR

# Self Adhesive ISM – Standard Window



1

Ensure the window surround is complete and ready to receive the ISM.

Mark up the sub strate to ensure the correct bond widths are achieved. The required bond widths are; 100mm onto porous surfaces (concrete etc) and a minimum of 20-30mm onto non-porous surfaces.

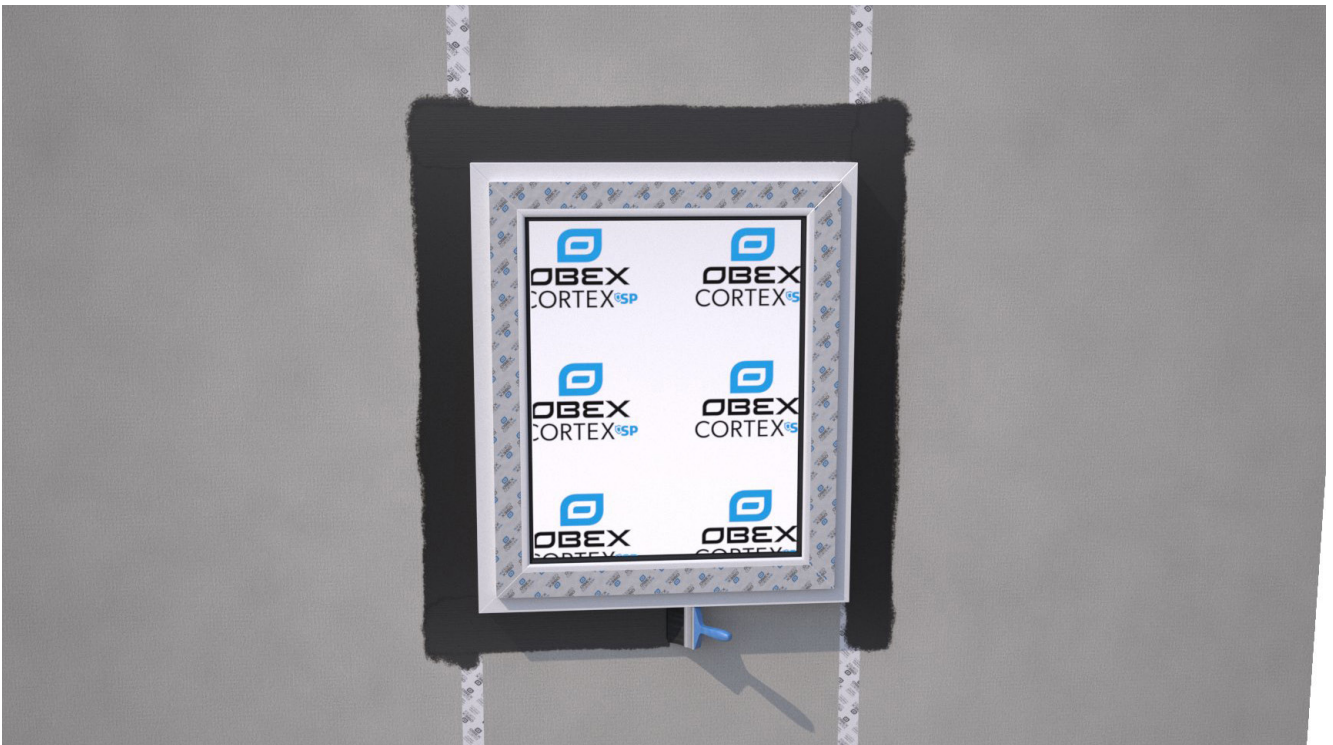

2

Apply OBEX CORTEX 0787FR Primer to porous surfaces. Ensure a full coverage over the bonding area. Porous surfaces include cement board, calcium silicate board, concrete etc.





3

Measure the length of the section and cut the membrane to the correct length. Remember to allow approx. 100mm overlap past the corners of the glazing unit.

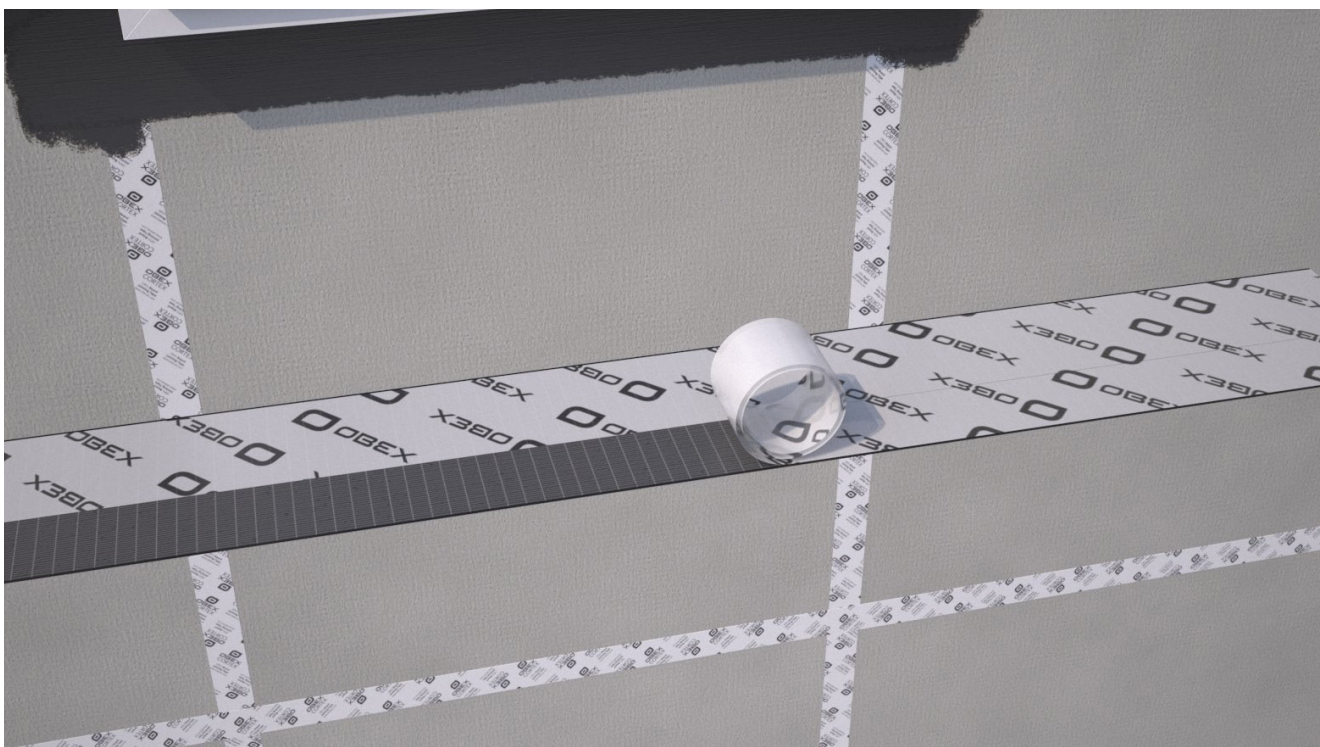

4

Remove the release liner from one side of the membrane.



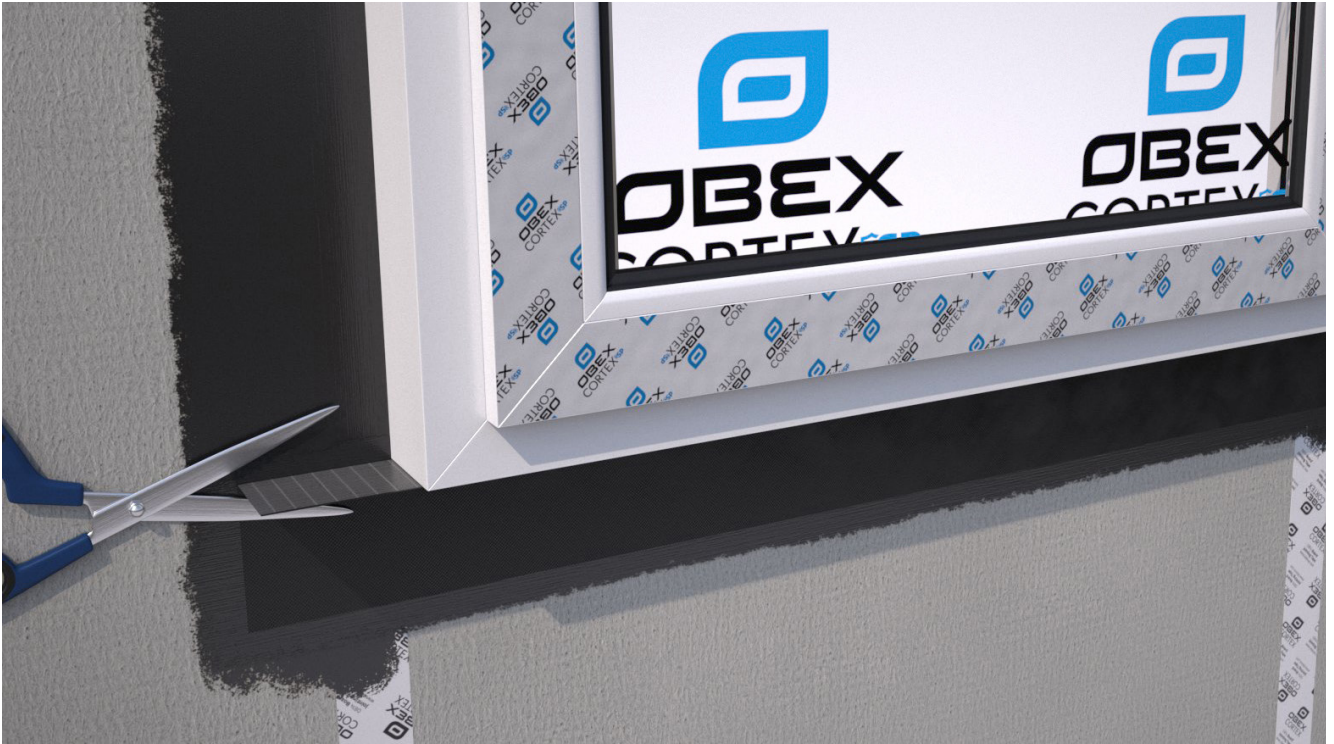

5

Bond the membrane in position starting at the window frame. Once positioned and bonded, the corner laps can be cut and folded into position.



6

Remove the release liner from the second half of the membrane.



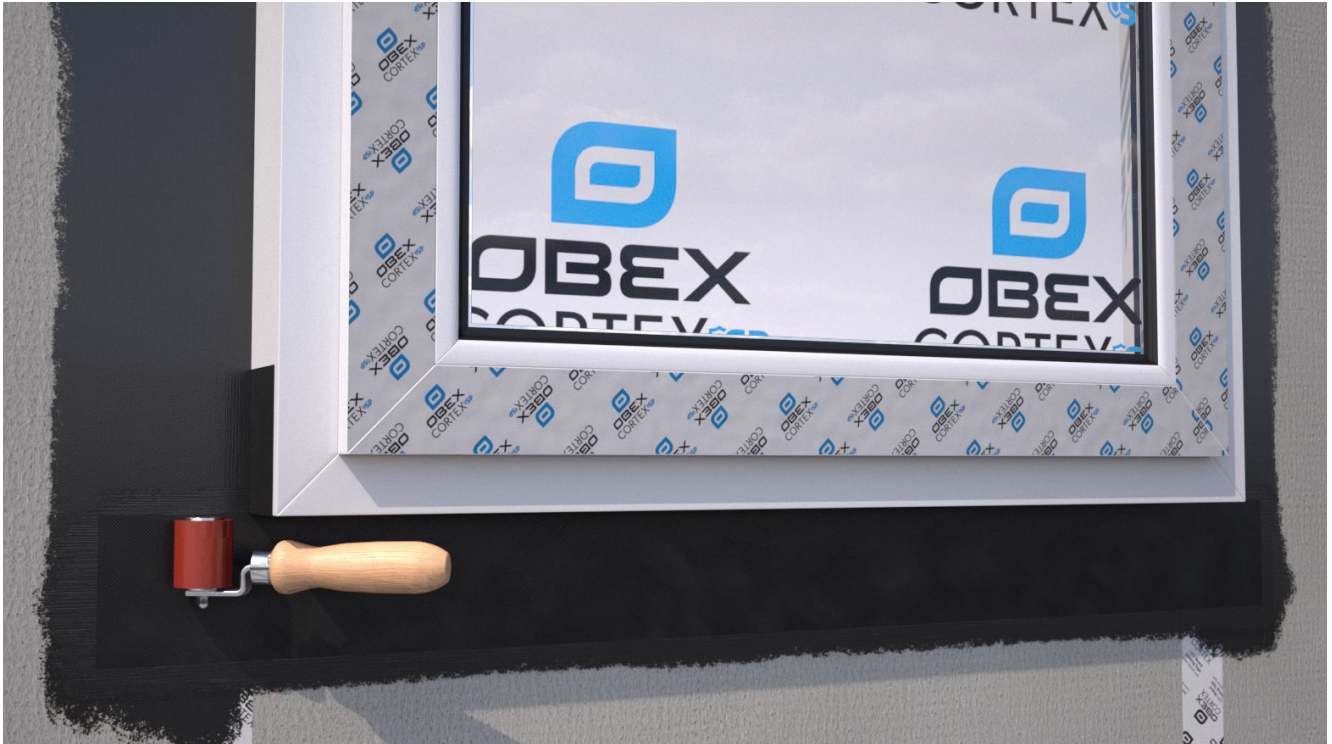

7

Bond the second half of the membrane into position and firmly roll with a roller.

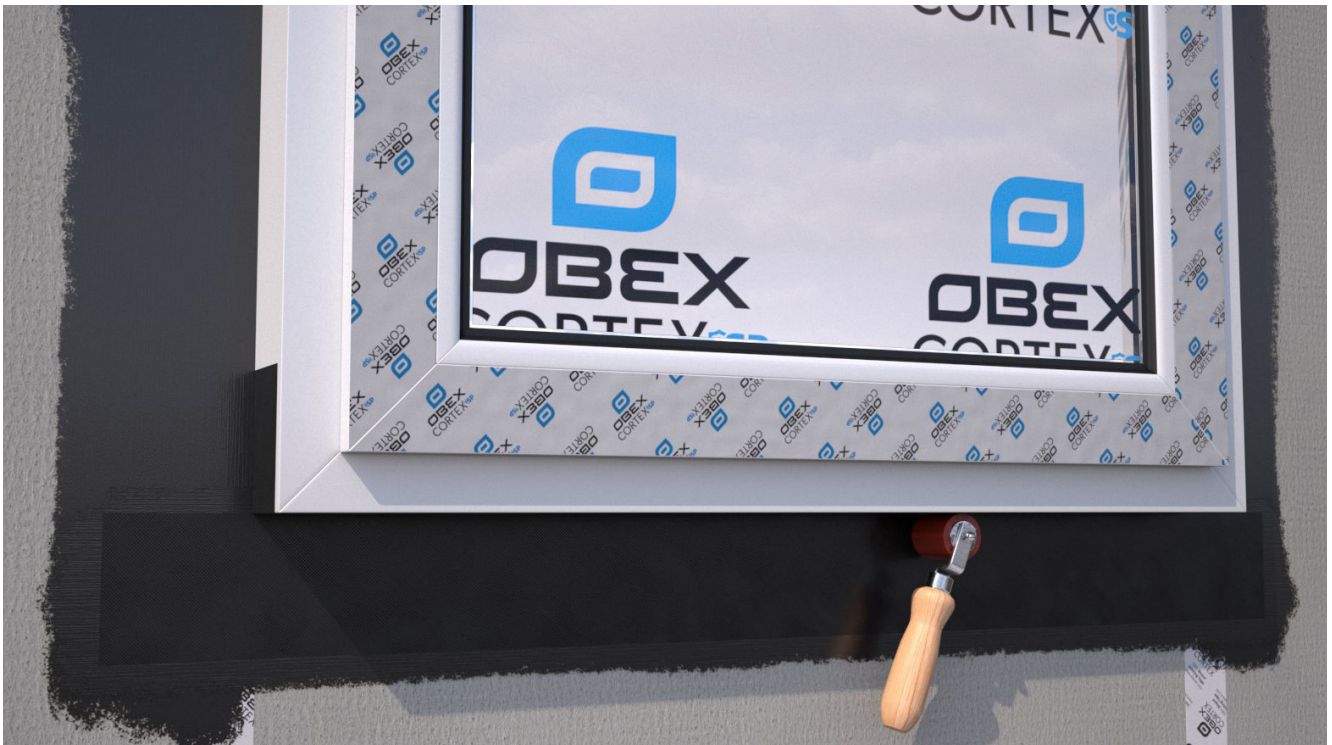

8

Ensure all surfaces are firmly rolled to ensure maximum bond strength is achieved.



9

Apply a small section of OBEX CORTEX 077 1FR Class B Paste Adhesive to the corner area as shown. (both sides of the window frame)



10

Repeat steps 3-9 for each side of the window frame.





11

Spread out the paste adhesive using an adhesive spreader.

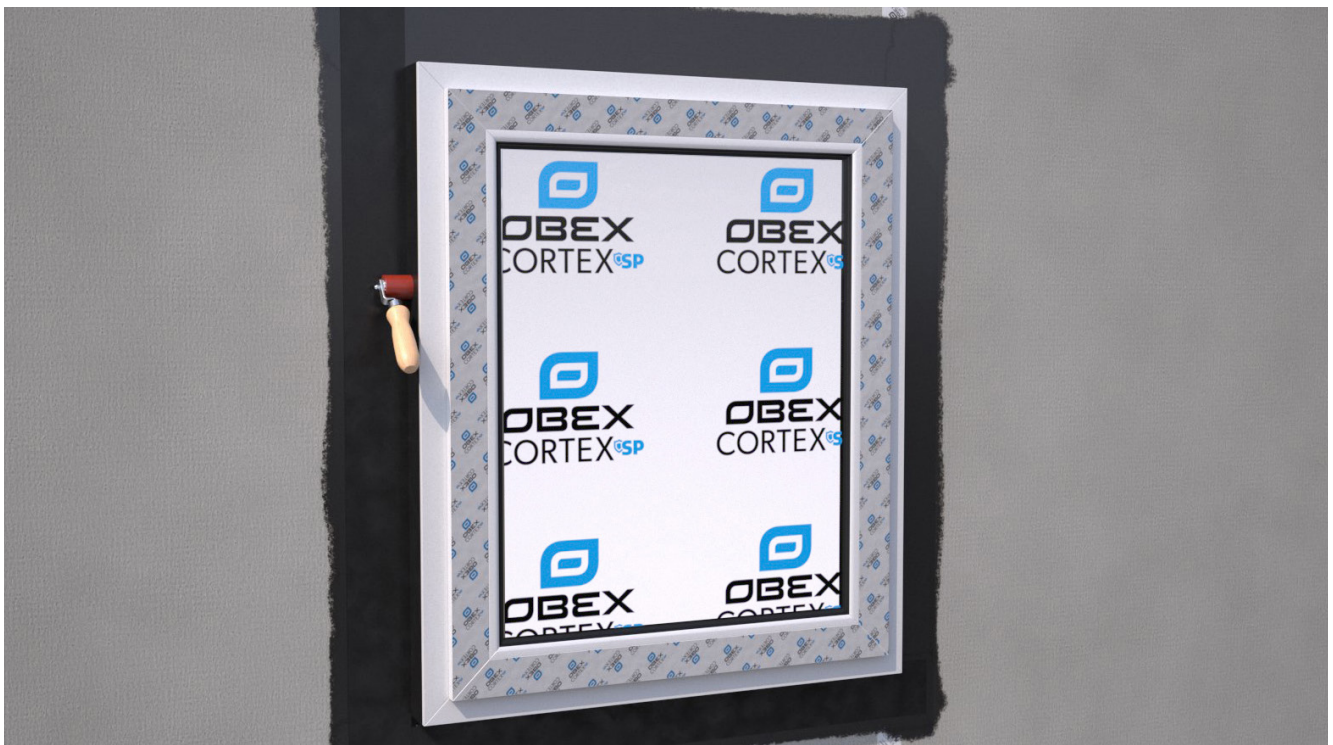

12

Remove the release liner from the second half of the membrane and bond in place. Ensure all surfaces are firmly rolled for maximum bond strength.



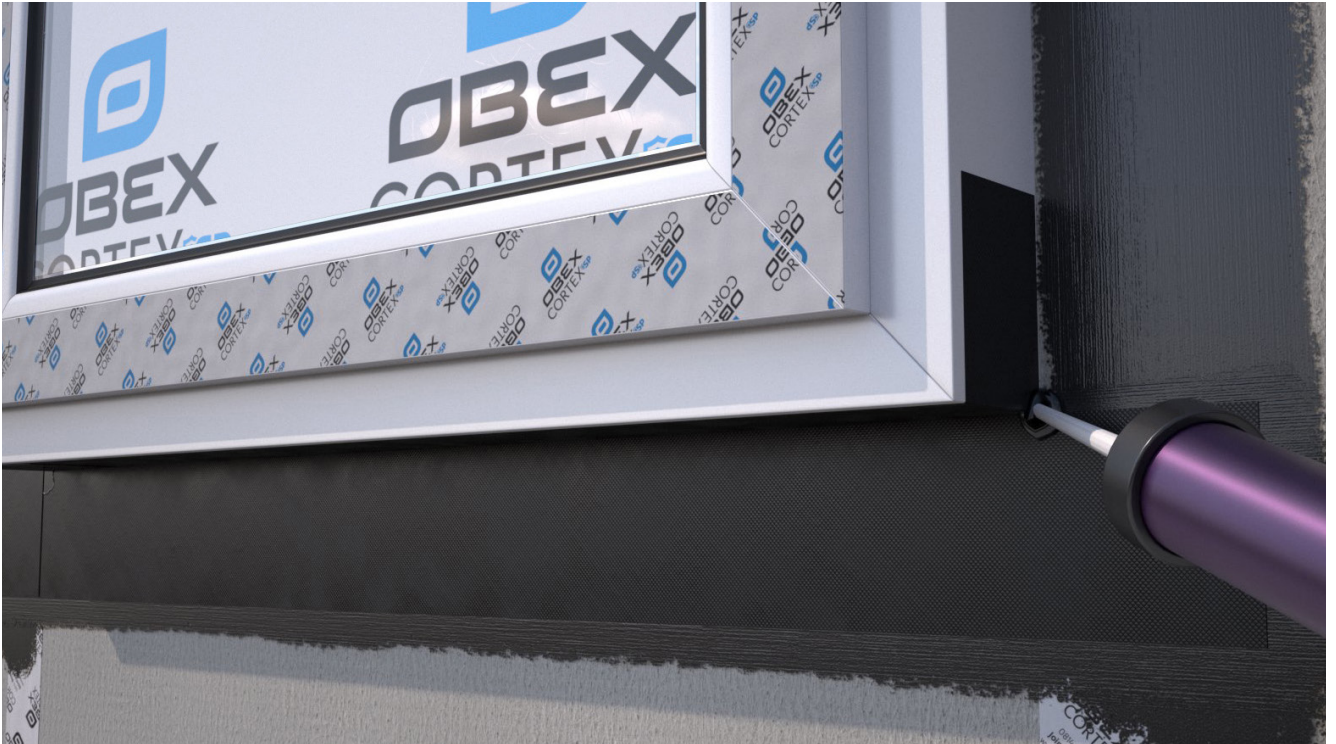

13

Ensure a small amount of OBEX CORTEX 0771FR Class B Paste Adhesive is applied in the corner areas as shown.

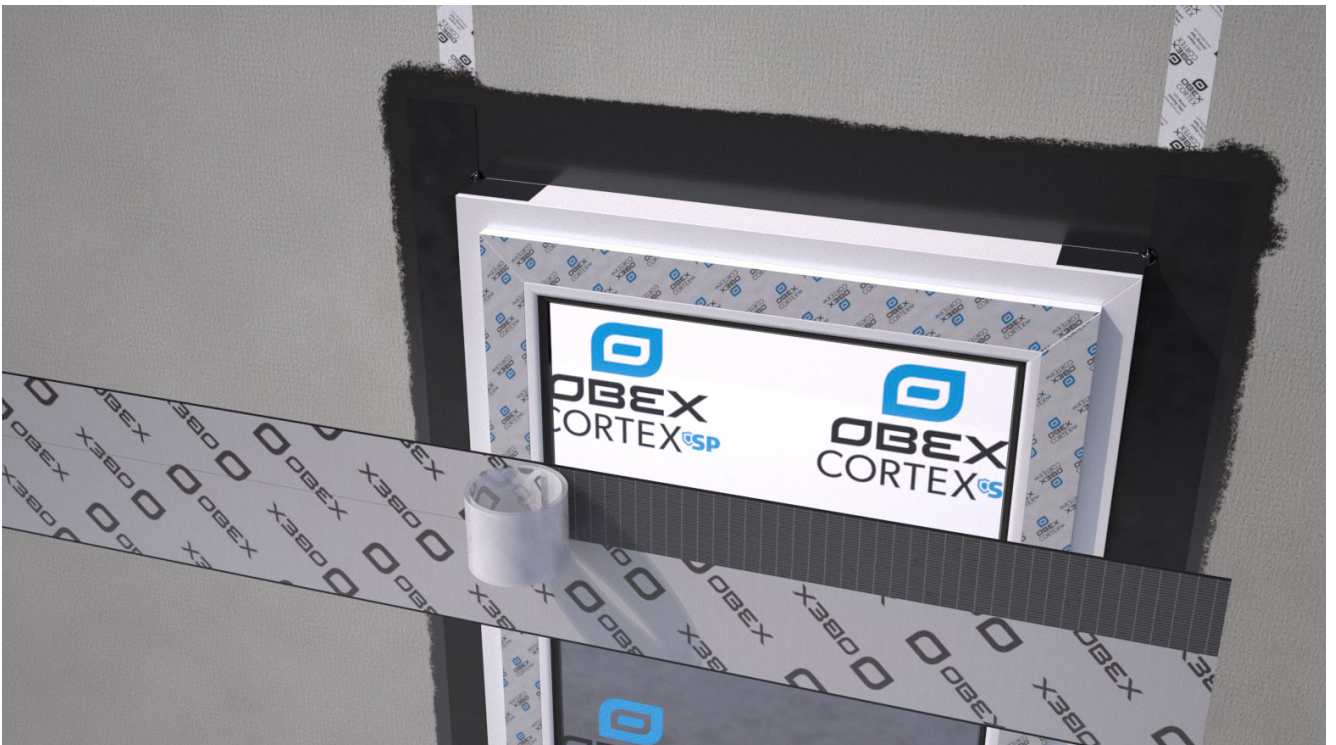

14

Repeat the same procedure for the Head membrane.



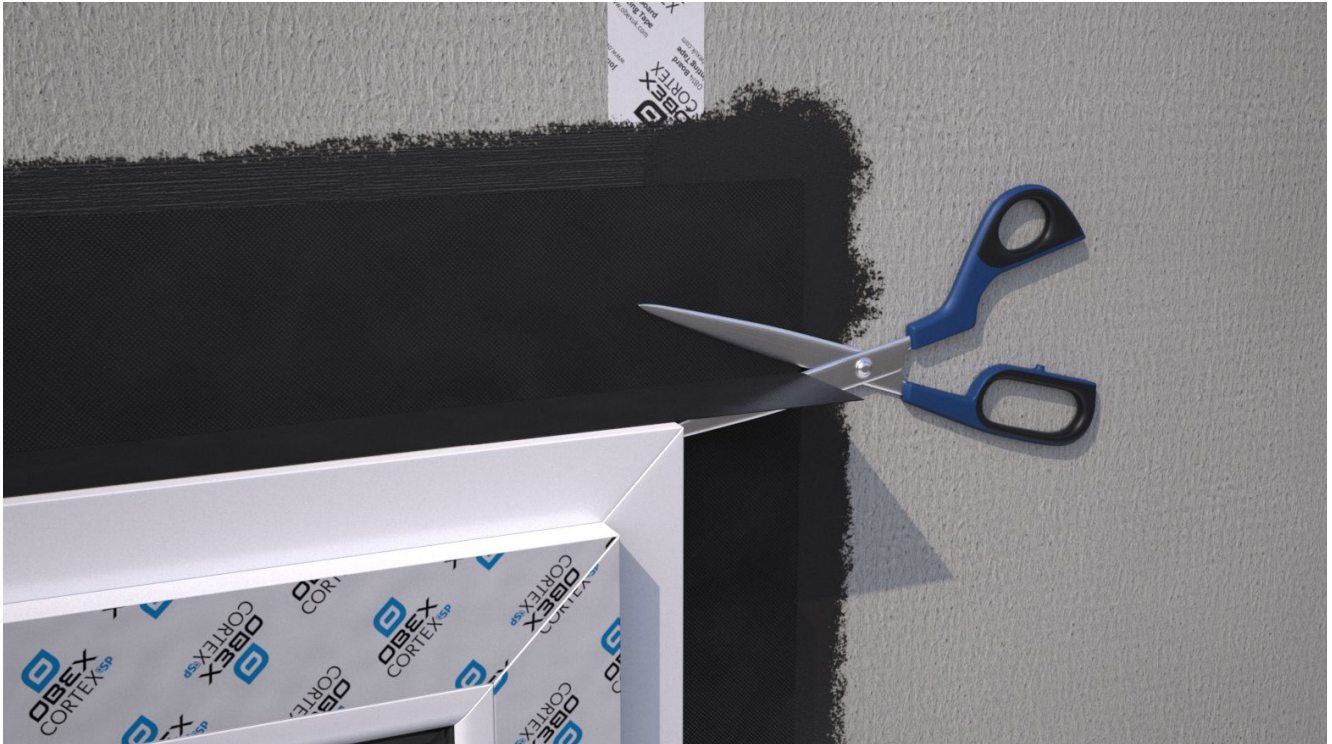

15

Cut and fold the corner laps into position.



16

Ensure all membrane surfaces are firmly rolled with a roller for maximum adhesion levels.





17

Apply a bead of OBEX CORTEX 0771FR Class B Paste Adhesive around all edges/joints/overlaps of the OBEX CORTEX 0560FR Class B Self Adhesive ISM.



18

Tool-off the bead of adhesive with a spreader to ensure all edges/joints/overlaps are fully sealed.



19

This is how ISM's around windows should look once complete.







**OBEX Protection Ltd.** Unit 5 St. Modwen Park, Norton Road, Broomhall, Worcester, WR5 2QR

**Call:** +44 (0) 1905 337800 | **Email:** sales-uk@obexglobal.com | **Visit:** www.obexglobal.com

© Copyright 2024 OBEX. All rights reserved. Company Registration No. 09157067, VAT No: 868 7649 48