

 INSTALLATION GUIDE

OBEX  **CORTEX^{FR}**

0521FR

Self Adhesive Breather Membrane

Class B

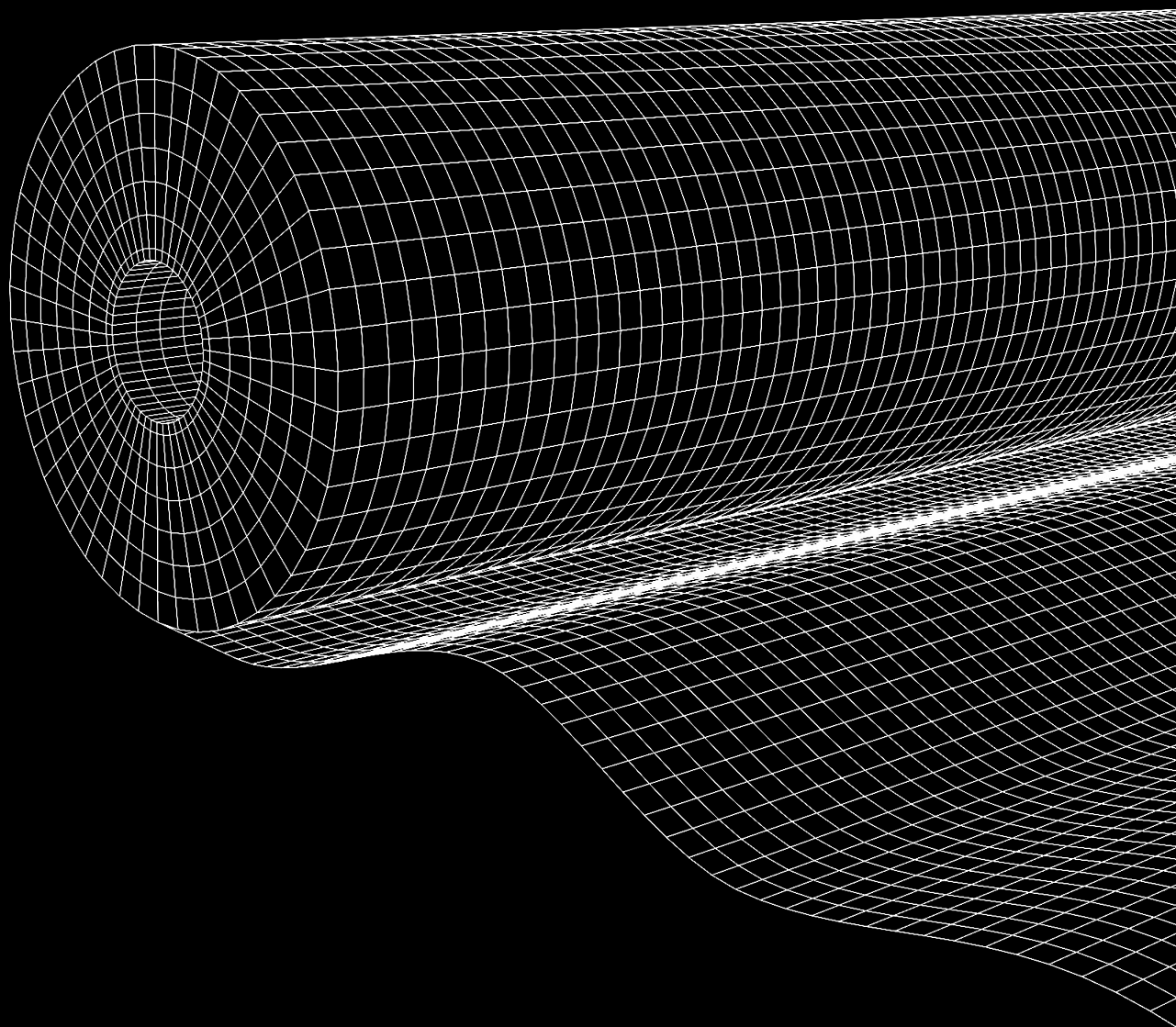

 **OBEX**[®]

VERSION: 01.01.04

Important Notes

- » Ensure the wall's surface is dry and free of dust and debris before installation.
- » When applying the membrane, ensure sufficient pressure is applied for best adhesion. Due to the adhesive being pressure sensitive, membranes applied with insufficient pressure will not adhere correctly.
- » Use a roller when installing for optimal adhesion.
- » Ensure that any membrane overlaps are 100mm at minimum.
- » Overlaps of at least 300mm should be allowed on corners.
- » It is vital to follow correct membrane sequencing - ISM's or EPDM must be installed first and then Breather Membranes over the top, and installed so that the Breather overlaps the ISM.
- » Repairs can be made using a patch of material which extends 50mm past the furthest extent of the damaged area in all directions.
- » It is the responsibility of the user/installer to ensure that compatibility with the bonding substrates has been checked. For any substrates with low adhesion, we recommend sealing the edge of the membrane with a suitable sealant from the OBEX range. E.g. bonding to coated substrates or silicone surfaces.
- » It is recommend to apply an ISM (Interface Sealing Membrane) around the SFS infill sections before the Breather Membrane is installed.
- » Application temperature - above 5°C.
- » Storage temperature 10°C - 30°C .



1

Peel back a section of the top release liner and apply the top corner of the membrane onto the substrate at the desired position. Start from the bottom and work upwards, ensuring that upper layers lap over lower layers.



2

Use a hand roller to ensure a firm bond onto the substrate.



3

Continue to remove the top release liner, whilst simultaneously applying the membrane to the substrate. Use the roller to ensure it is firmly adhered.

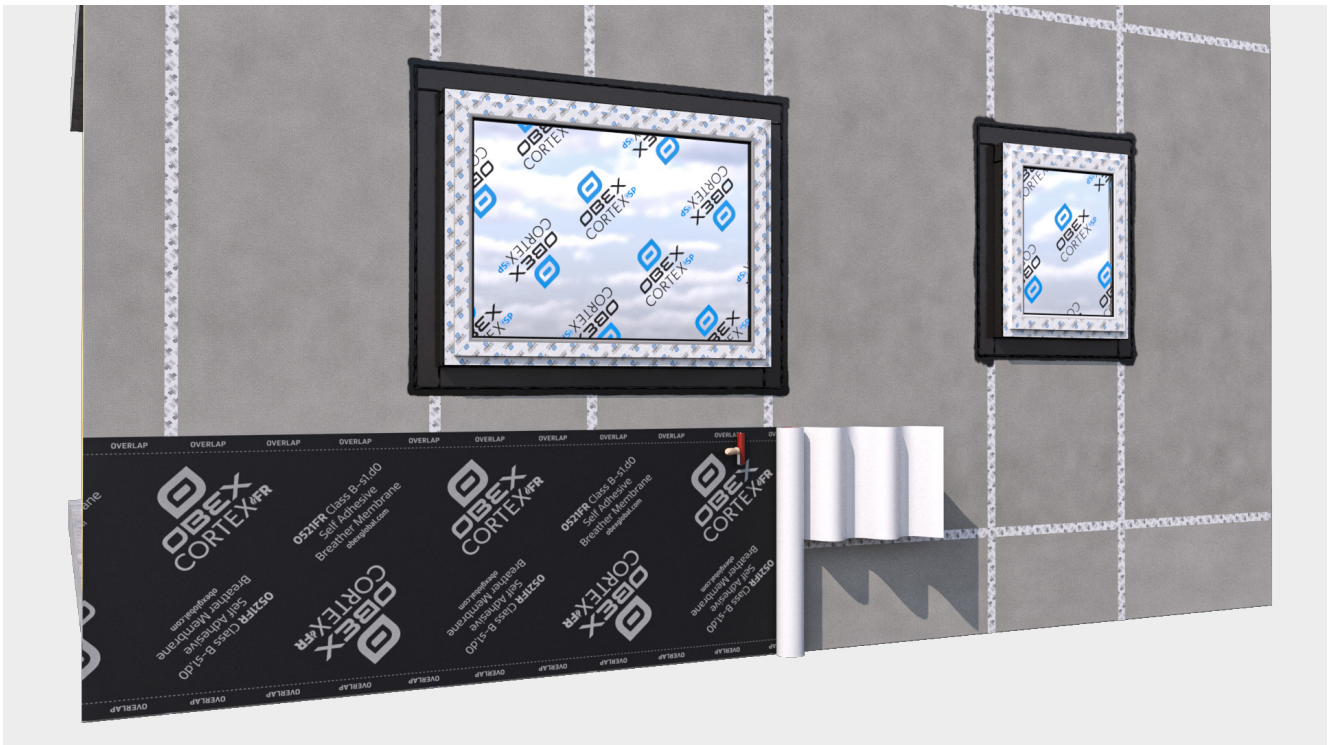

4

Continue to the end of the section.



5

For maximum adhesion, use the roller to apply pressure up to the edges of the membrane.



6

Use a knife or shears to cut the membrane at the edge of the section.



7

Now peel away the lower section of the release liner and affix the membrane to the substrate as before.

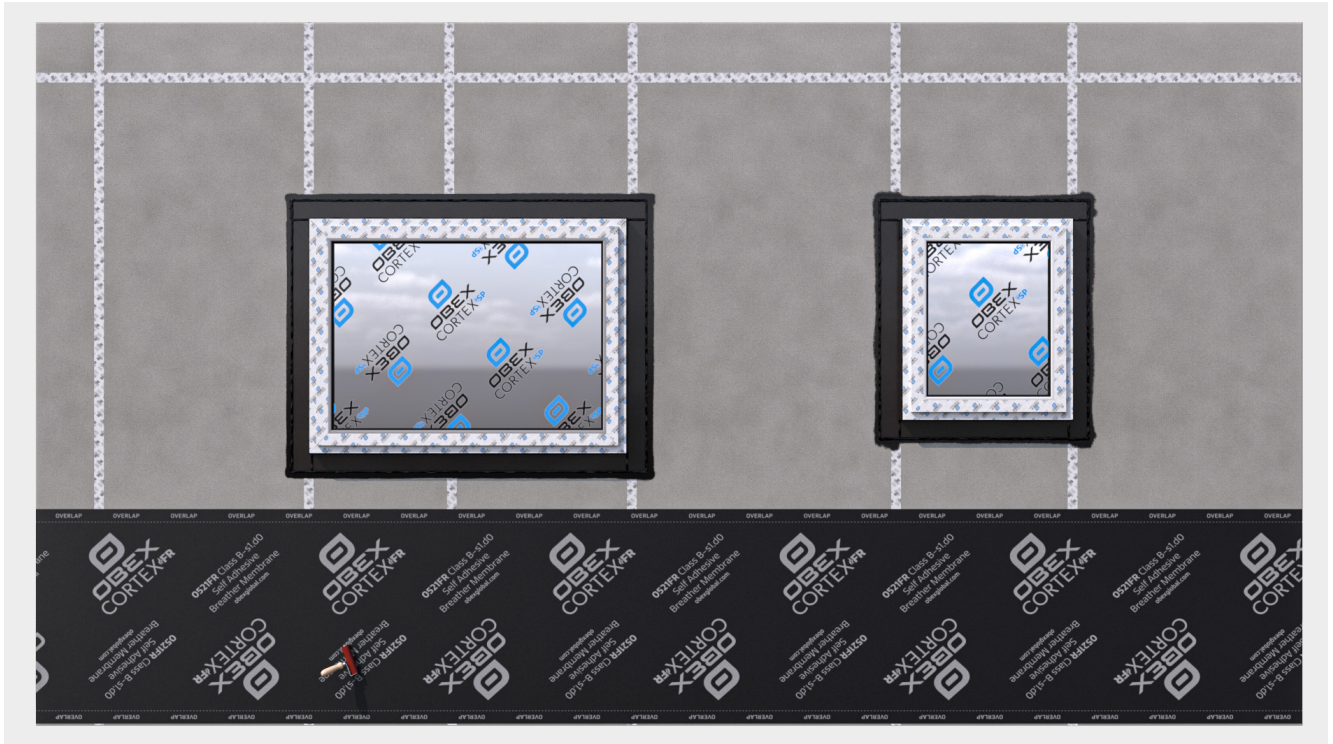

8

Remove the release liner and affix the lower half of the membrane, using the roller to ensure a good bond.

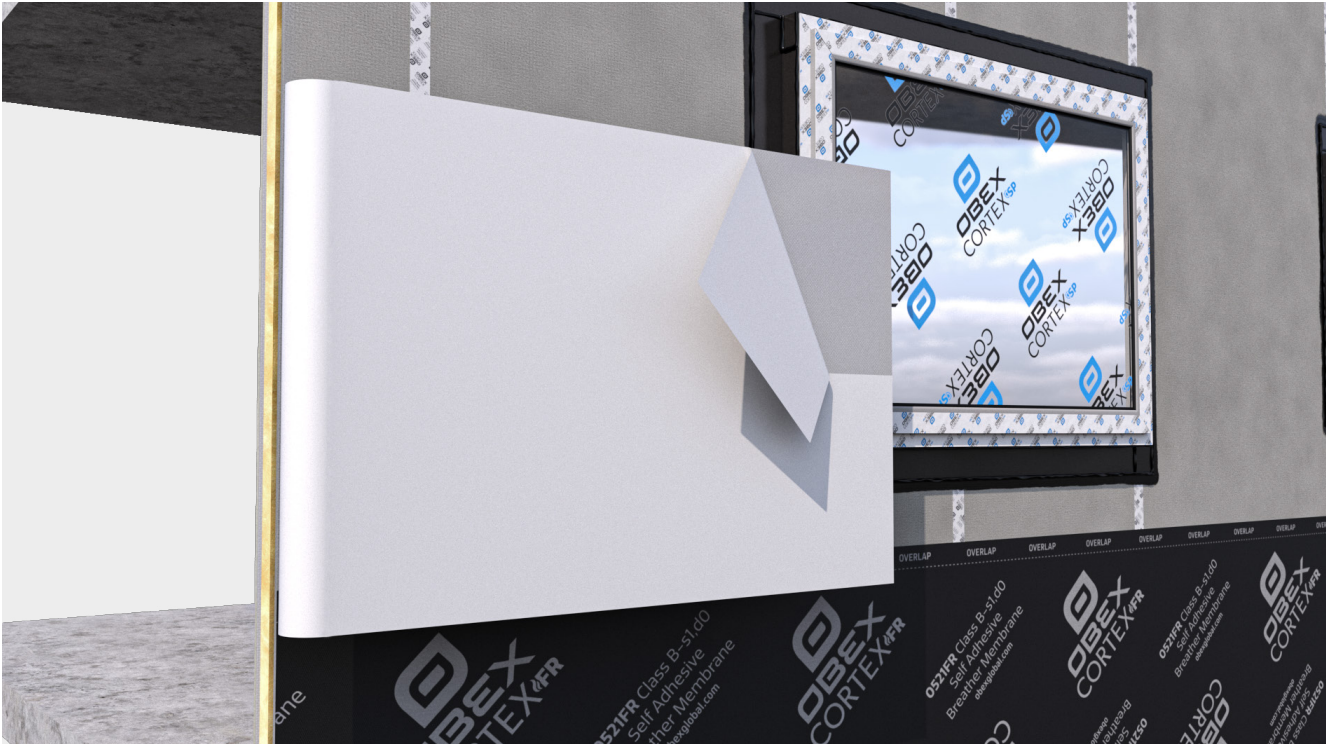

9 For additional horizontal layers, repeat the process, ensuring that each layer overlaps the one below by a minimum of 100mm.



10 If the façade includes windows, adhere the membrane up to the edge of the window frame.



11

Cut the membrane to length, allowing 100mm to overlap the ISM (Interface Sealing Membrane) around the window. Use Membrane Shears rather than a knife, to ensure the ISM is not damaged.



12

Only cut down as far as the bottom corner of the window, unroll the membrane across the window and repeat the same length cut on the opposite side.



13

Fold the cutout down and continue to remove the upper section of the release liner, bonding the membrane to the wall.

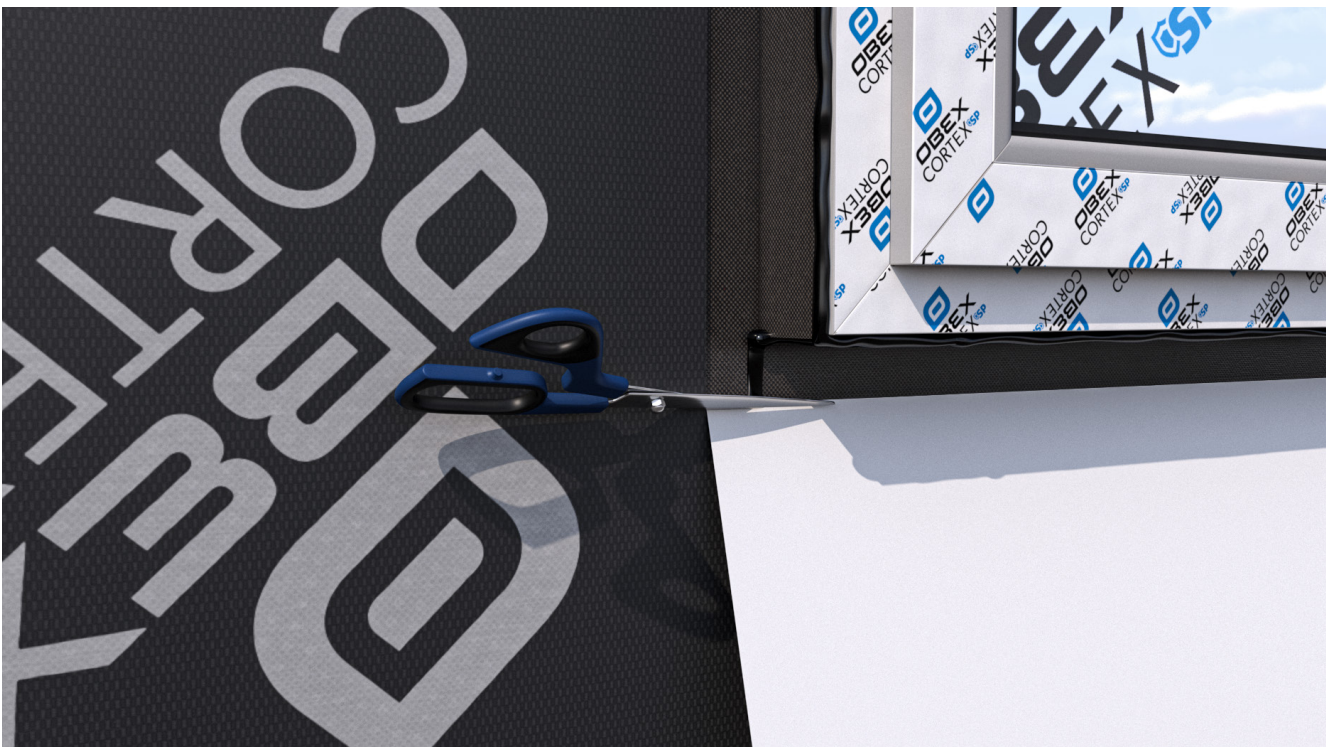

14

Once the end of the section is reached, remove the window cutout, allowing a 100mm overlap onto the ISM.

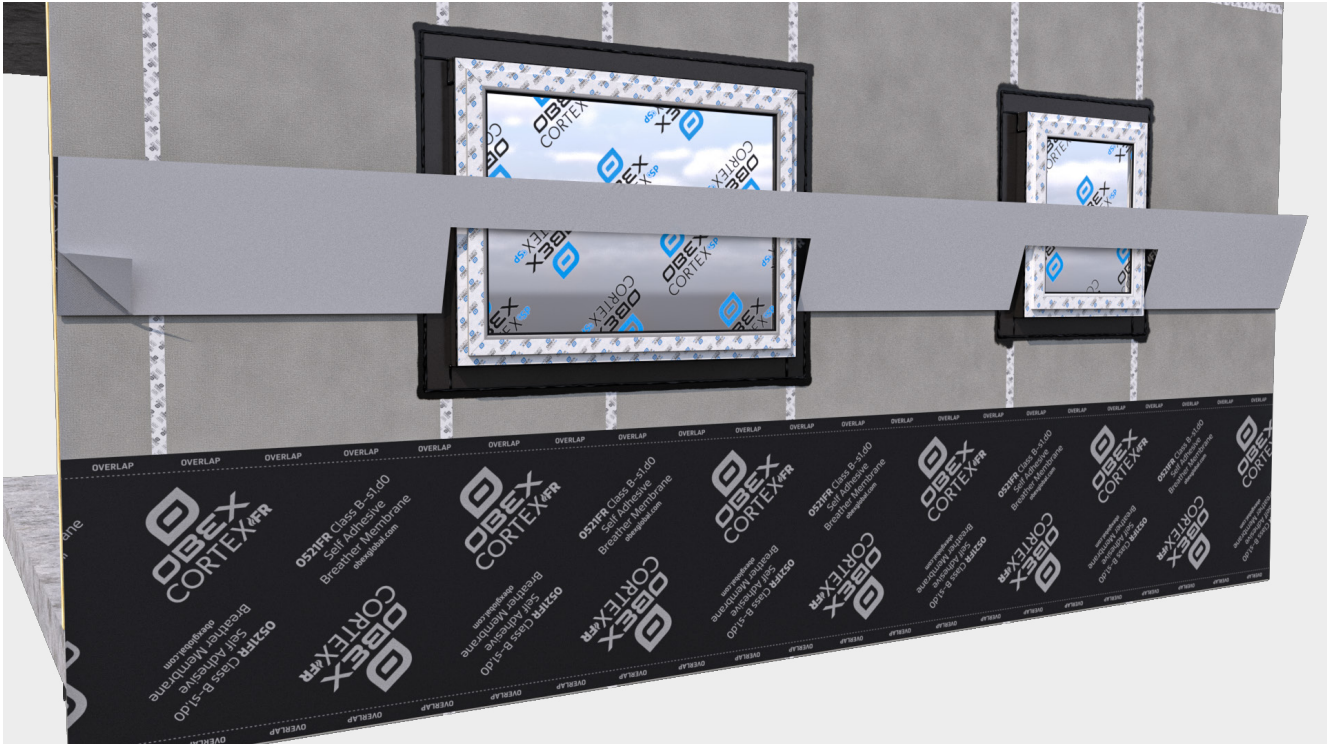

15

Now repeat steps 7 & 8 to affix the lower section of the membrane.

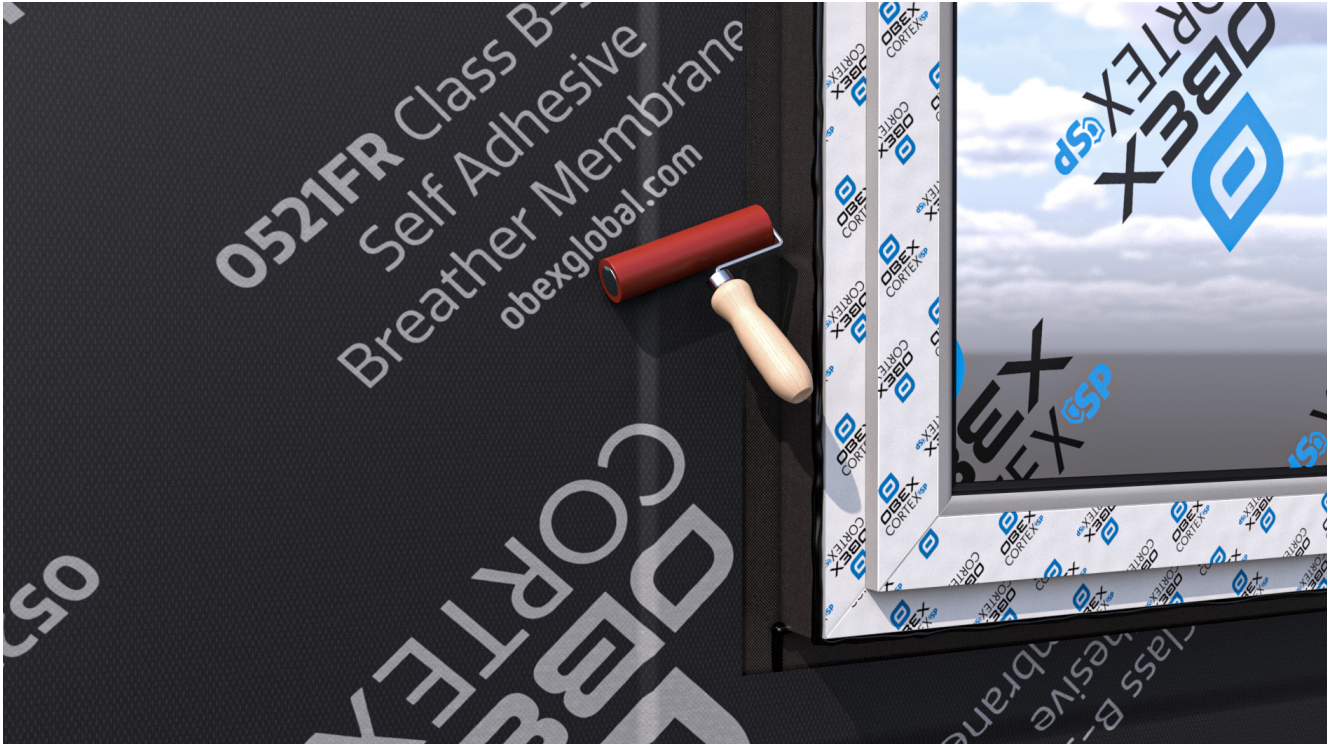

16

Use the roller to ensure that the edge of the membrane is bonded firmly onto the ISM around the window.

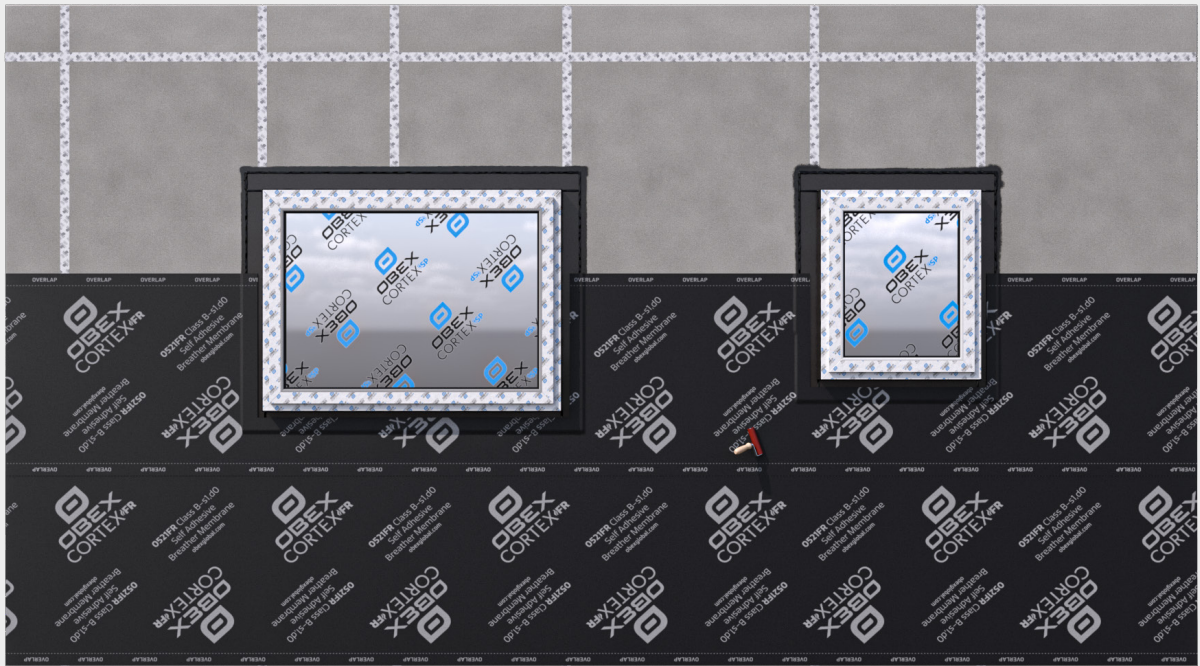

17

Repeat steps 10 to 14 to apply the membrane around each window.

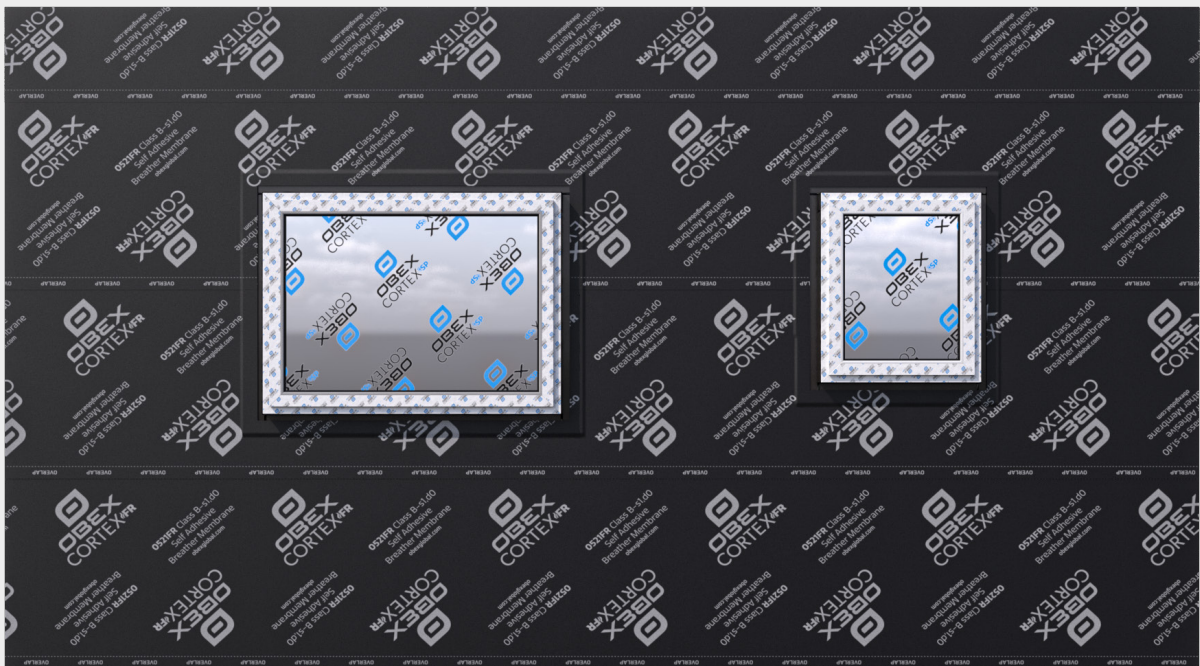

18

Make such that each layer of membrane overlaps the one below by 100mm.



OBEX Protection Ltd. Unit 5 St. Modwen Park, Norton Road, Broomhall, Worcester, WR5 2QR

Call: +44 (0) 1905 337800 | **Email:** sales@obexuk.com | **Visit:** www.obexglobal.com

© Copyright 2024 OBEX. All rights reserved. Company Registration No. 09157067, VAT No: 868 7649 48